

You can create these other buildings or design your own!



TIP FOR PARENTS:
Because LINCOLN LOGS pieces are colored and stained in the traditional manner, the dyes can rub off. Use is recommended on surfaces that can be wiped clean. Avoid placing the logs directly on carpet and other absorbent surfaces, which may cause staining.

THE ORIGINAL
LINCOLN LOGS
AMERICA'S NATIONAL TOY™

AGES
3+
00858

REAL WOOD LOGS!



WARNING:
CHOKING HAZARD – Small parts.
Not for children under 3 years.

k'nex

Basic Fun! **k'nex** basicfun.com
@knex facebook.com/lincolnlogs

Licensed By: **Hasbro** 100858-V1-07/19

FUN ON THE FARM

The Basic Fun logo, product and package design. 2019 K'NEX, a Division of Basic Fun, Inc., 301 Yamato Road, Suite 4200, Boca Raton FL 33431, USA. K'NEX is a registered trademark of Basic Fun, Inc. Instructions are included for the model shown on the package front. HASBRO and its logo and LINCOLN LOGS are trademarks of HASBRO and are used with permission. ©2019 HASBRO. All Rights Reserved. Product & colors may vary. Most models can be built one at a time.

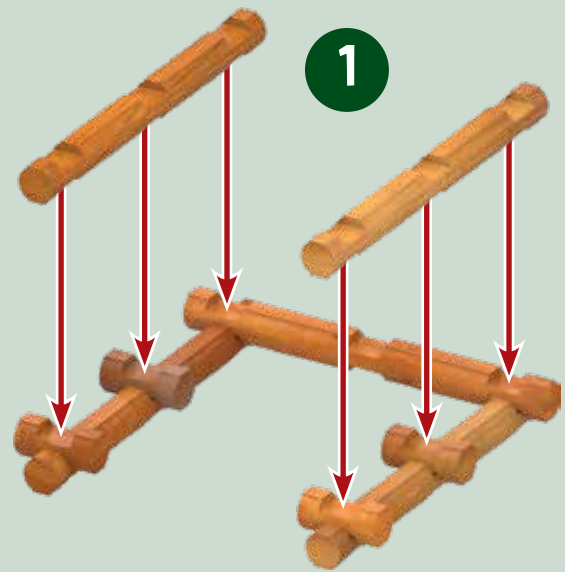

1

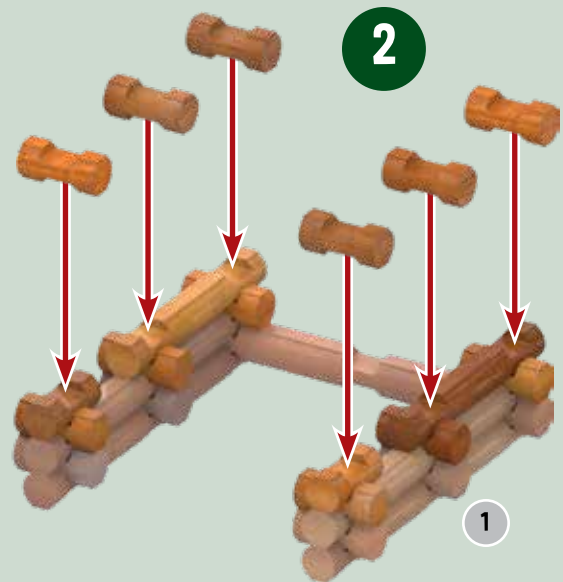

2

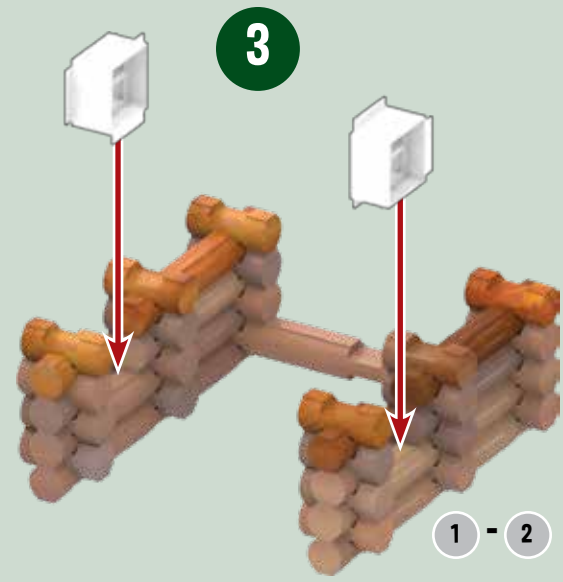

3

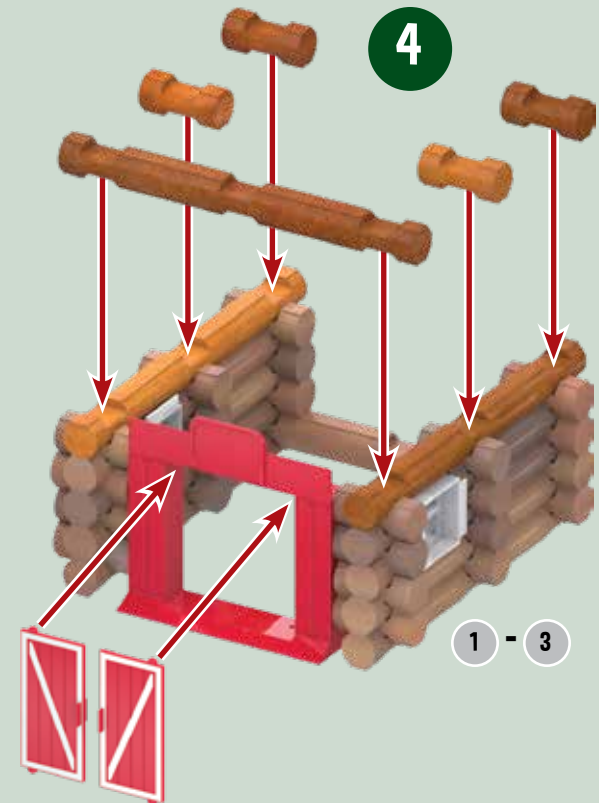

4

Step 4

3

4

1

1

Before you build, find and count out the parts you need for each step!

Step 1

4

5

Step 2

14

2

Step 3

8

2

2

1 - 4

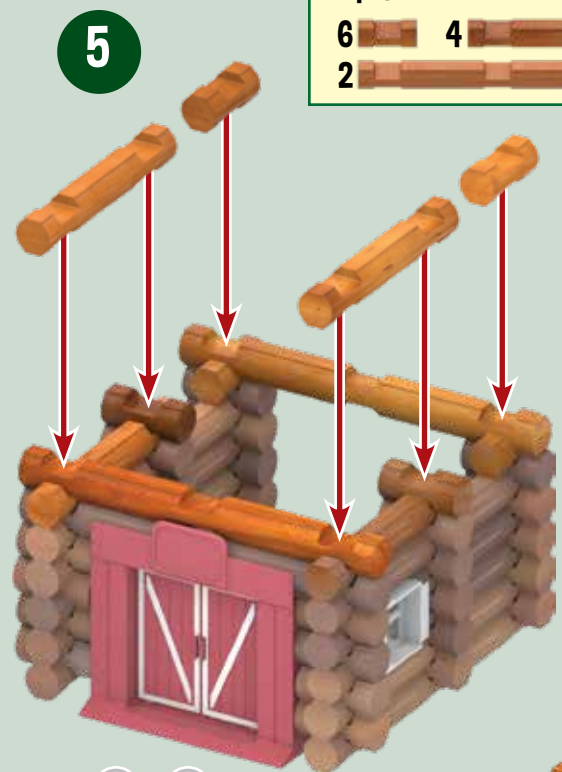

5

Step 5

6

4

2

Step 6

3

4

12

2

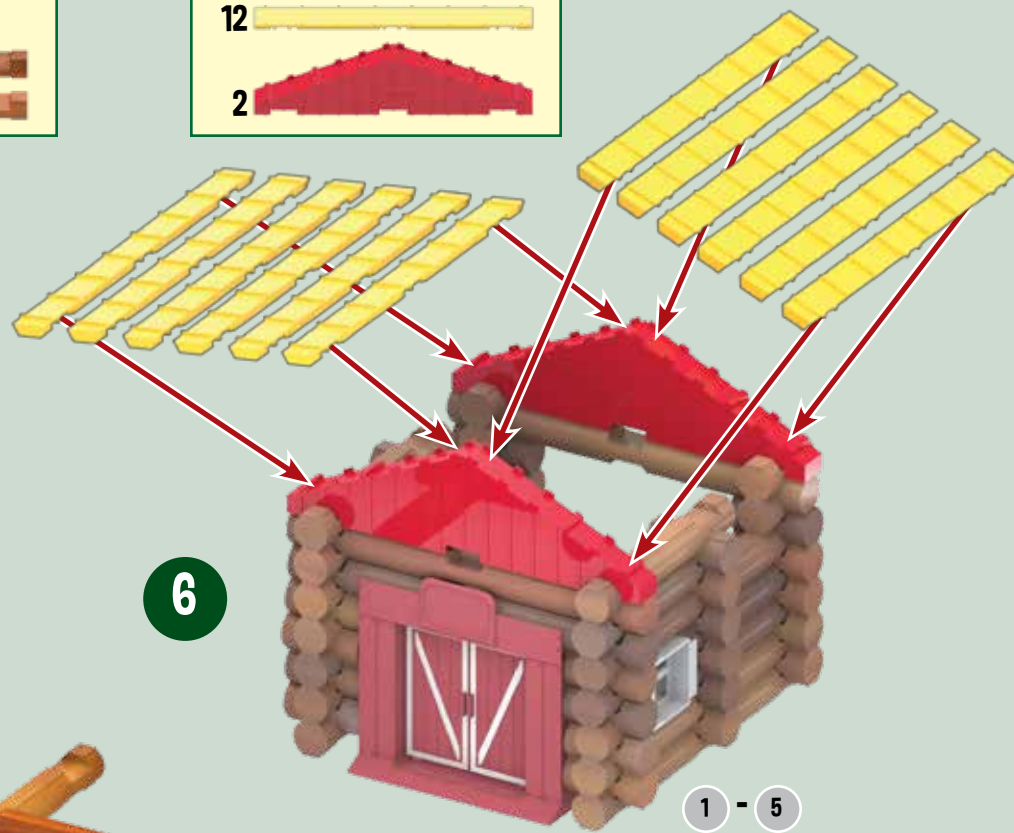

6

1 - 7

Step 7

6

2

1

1

1

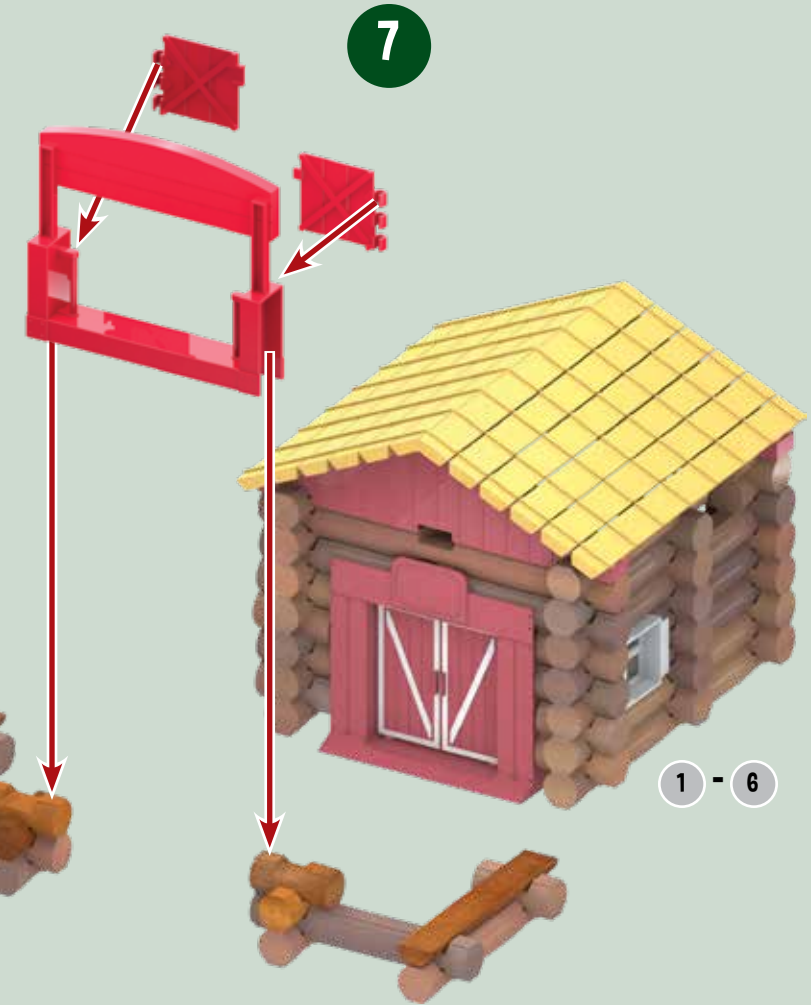

7

1 - 6