

AGES 6+  
15039

# STAR WARS™ SCIENCE™

## DARTH MAUL™ EDITION LIGHTSABER™ ROOM LIGHT

ASSEMBLY: Tool required - small Phillips-head screw driver - 3

### PARTS INCLUDED:

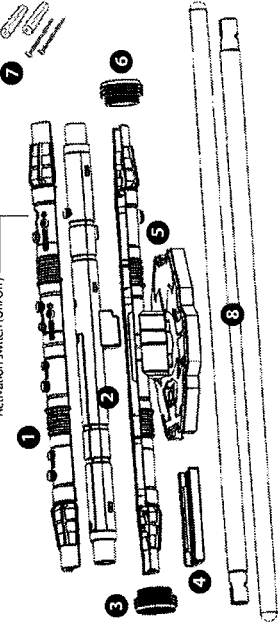
- 1 Hilt (front half)
  - 2 Battery/Electronics pack
  - 3 Bottom cap
  - 4 Wall mounting bracket
  - 5 Hilt/Wall plate
  - 6 Top cap
  - 7 Wall mounting hardware (2 screws and 2 expansion sleeves)
  - 8 Blades
- Activation switch (On/Off)
- 

Note: If the lightsaber blade is slightly curved, it can be straightened by rolling it on a clean, flat, smooth surface with the palm of your hand.

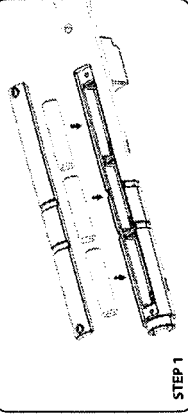

Align Hilt (front half) 1 using location pins and press to close.

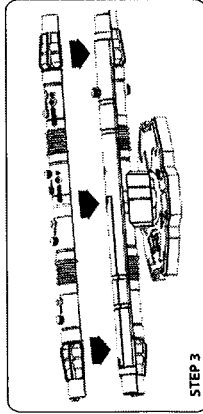

Insert 3 AAA batteries into Battery/Electronics pack 2 as indicated in the battery compartment.

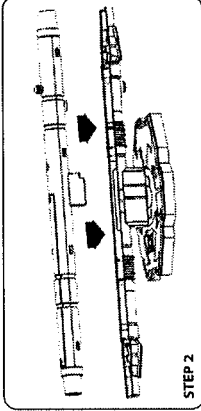

Place Battery/Electronics pack 2 into Hilt/Wall plate 5.

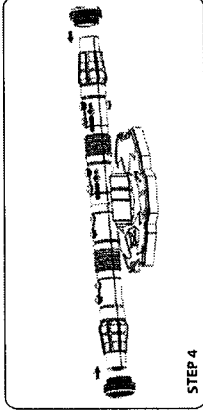

Insert Bottom cap 3 and Top cap 6 into the key details on the Hilt.

**KEEP THESE INSTRUCTIONS FOR FUTURE REFERENCE - DO NOT DISCARD**

Questions? Visit us at [undermilton.com](http://undermilton.com)

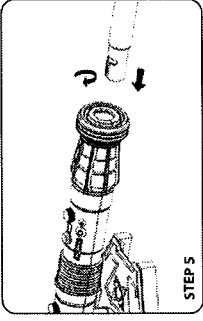

Insert the Blades 8 into the Hilt. Align the Blade groove with tabs in the Hilt and turn clockwise to lock it in place.

### WALL INSTALLATION:

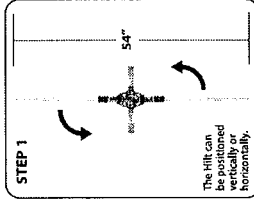

Choose a location for installation. Make sure there is an unobstructed area around for the blade.

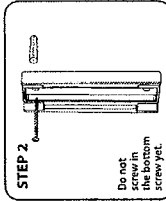

Slide the assembled Hilt and Wall plate half-way onto the Wall mounting bracket. Confirm the blade is vertical and mark a spot on the wall through the lower bracket-hole. Remove Hilt assembly, and complete installation with lower screw, and replace Hilt assembly.

**Warning:** Product must be assembled by an adult. This product contains small parts which are necessary for assembly. Prior to and during assembly of this product, keep small parts out of children's reach. Small parts pose a choke hazard to children under 3 years.

### OPERATION:

1. To turn lightsaber ON or OFF, press the activation switch on the front of the lightsaber handle.
- Note:** To conserve battery life, your lightsaber will turn off automatically after 15 minutes.

Caution: Do not view light sources directly without blades installed.



### BATTERY SAFETY INFORMATION

- Non-rechargeable batteries are not to be recharged
- Rechargeable batteries are to be removed from the toy before being charged
- Rechargeable batteries are only to be charged under adult supervision
- Different types of batteries or new and used batteries are not to be mixed
- Batteries are to be inserted with the correct polarity
- Exhausted batteries are to be removed from the toy
- Do not mix old and new batteries
- Do not mix alkaline, standard (carbon/zinc) or rechargeable (nickel-cadmium, batteries)
- Do not dispose of batteries in fire. Battery may explode or leak.

This device complies with Part 15 of the FCC Rules.

Operation is subject to the following two conditions:  
(1) This device may not cause harmful interference, and  
(2) This device must accept any interference received, including interference that may cause undesired operation.

Caution: changes or modifications not expressly approved by the party responsible for compliance could void the user's authority to operate the equipment.

Conforms to safety requirements of ASTM F963

NOTE: This equipment has been tested and found to comply with the limits for a Class B digital device, pursuant to Part 15 of the FCC Rules. This equipment is designed to provide reasonable protection against harmful interference in a residential installation. This equipment generates, uses and can radiate radio frequency energy and if not installed and used in accordance with the instructions, may cause harmful interference to radio communications. However, there is no guarantee that interference will not occur in a particular installation. If this equipment does cause harmful interference to radio or television reception, which can be determined by turning the equipment off and on, the user is encouraged to try to correct the interference by one or more of the following measures:

- Reorient or relocate the receiving antenna.
- Increase the separation between the equipment and receiver.
- Connect the equipment into an outlet on a circuit different from that to which the receiver is connected.
- Consult the dealer or an experienced radio/TV technician for help.

**WARNING:**  
CHOKING HAZARD - Small parts.  
Not for children under 3 years.  
Adult assembly required.



© 2012 Undermilton. All rights reserved.  
Wardworld Design, U.S. Masters of Uncle Milton Industries, Inc.  
P.O. Box 5281 Thousand Oaks, CA 91320 USA. PRINTED IN CHINA  
Product and color may vary.  
© 2012 Undermilton Ltd. & s or its wholly owned subsidiaries.  
All rights reserved.

1-800-828-2282

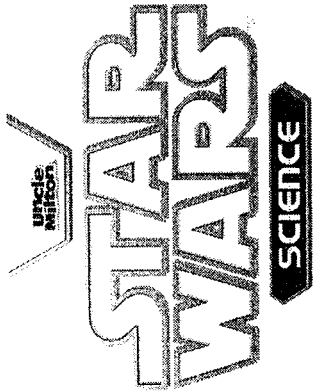

## REMOTE CONTROLLED LIGHTSABER™ ROOM LIGHT

**ASSEMBLY:** Tool required – small Phillips-head screw driver

### PARTS INCLUDED:

- 1 Hilt (front half)
- 2 Battery pack
- 3 Electronics pack
- 4 Hilt/Wall plate
- 5 Wall mounting bracket
- 6 Exterior cap
- 7 Blade
- 8 Remote control
- 9 Wall mounting hardware (2 screws and 2 expansion sleeves)

Activation switch (On/Off)

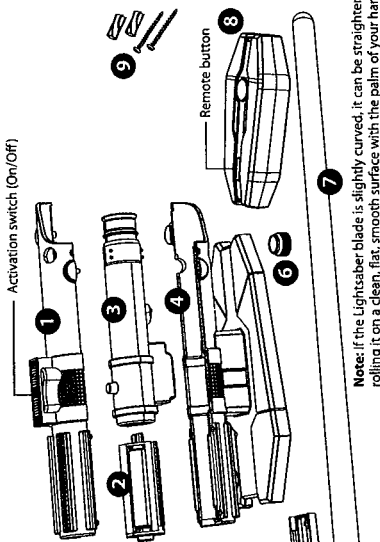

Note: If the Lightsaber blade is slightly curved, it can be straightened by rolling it on a clean, flat, smooth surface with the palm of your hand.

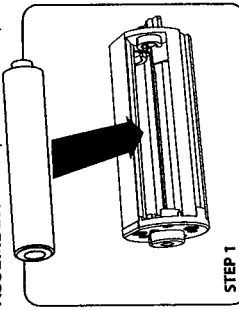

STEP 1

Insert 3 AAA batteries into Battery pack 2 as indicated in the battery compartment.

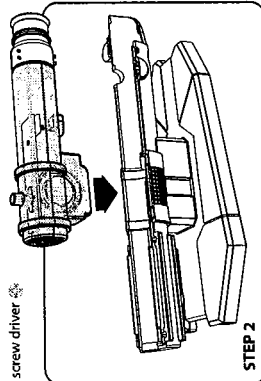

STEP 2

Place Electronics pack 3 into Hilt/Wall plate 4.

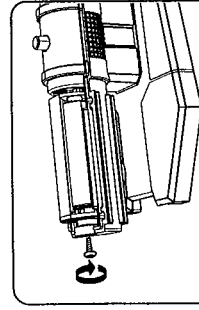

STEP 3

Tighten battery retainer screw to secure Battery pack in place.

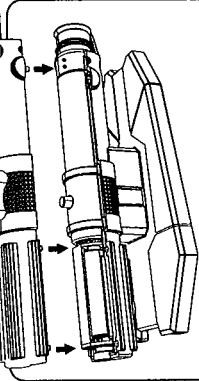

STEP 4

Align Hilt (front half) 1 using location pins and press to close.

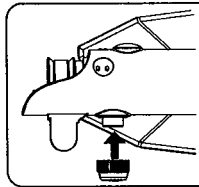

STEP 5

Slide Exterior cap 6 over Hilt post.

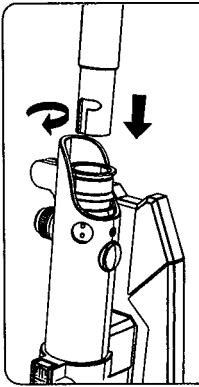

STEP 6

Insert the Blade 7 into the Hilt. Align the groove in the blade, with tabs in Hilt and turn clockwise to lock it in place.

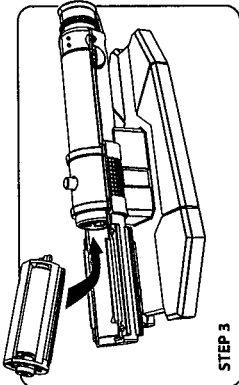

STEP 7

Insert Battery pack into Hilt handle. Align tab with slot in Electronics pack so contact is made.

**KEEP THESE INSTRUCTIONS FOR FUTURE REFERENCE — DO NOT DISCARD**  
 Questions? Comments?  
[info.unclemilton.com](http://info.unclemilton.com)  
 1-888-742-2484  
 or visit us at  
[unclemilton.com](http://unclemilton.com)

### WALL INSTALLATION:

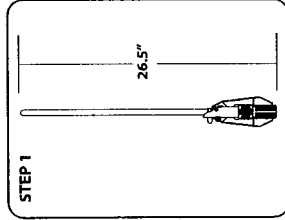

STEP 1

Choose a location for installation. Make sure there is an unobstructed area above for the blade.

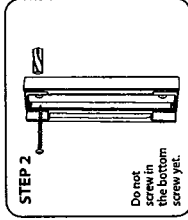

STEP 2

Locate stud in wall or use the Expansion sleeves included and screw the Wall mounting bracket to the wall using the top hole only.

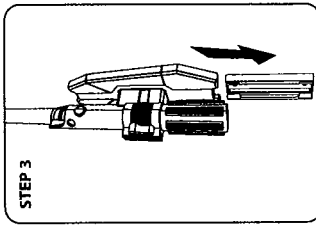

STEP 3

Slide the assembled Hilt and Wall plate half-way onto the Wall mounting bracket and mark a spot on the wall through the lower bracket hole once the blade is vertical. Remove Hilt assembly, screw in lower Screw with Expansion sleeve, and replace assembly.

### REMOTE CONTROL — INSTALLING BATTERIES

1. Use a Phillips-head screwdriver (not included) to remove battery door.
2. Insert 2 AAA batteries into remote. Make sure the "+" and "-" ends are inserted correctly as indicated in the battery compartment.
3. Replace battery door.

**Warning:** Product must be assembled by an adult. This product contains small parts which are necessary for assembly. Prior to and during assembly of this product, keep small parts out of children's reach. Small parts pose a choke hazard to children under 3 years.

### USER GUIDE: **Caution: Do not view light source directly**

1. To turn on lightsaber, press the activation switch on the front of the lightsaber handle.
2. Use the remote button to cycle through the color modes.
3. You can also use the button on the lightsaber to cycle through the color modes.
4. To turn the light OFF, cycle through all 9 modes until the lightsaber blade turns off and you hear the lightsaber shut-off sound.
5. To conserve battery life, your lightsaber will turn off automatically after 15 minutes. Note: Press the activation switch on the front of the lightsaber handle to turn the lightsaber back on.

Activation Switch On/Off

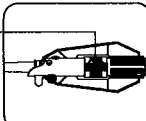

### BATTERY SAFETY INFORMATION

- Non-rechargeable batteries are not to be recharged
- Rechargeable batteries are only to be charged under adult supervision
- Rechargeable batteries are to be removed from the toy before being charged
- Different types of batteries or new and used batteries are not to be mixed
- Batteries are to be inserted with the correct polarity
- Exhausted batteries are to be removed from the toy
- The supply terminals are not to be short-circuited

### NOTE: This equipment has been tested and found to comply with the limits for a Class B digital device, pursuant to Part 15 of the FCC Rules.

- Operation is subject to the following two conditions:
- (1) This device may not cause harmful interference, and
  - (2) This device must accept any interference received, including interference that may cause undesired operation.
- Conforms to safety requirements of ASTM F963 and EN71
- WARNING:**  
**CHOKING HAZARD - Small parts.**  
 Not for children under 3 years.
- Reorient or relocate the receiving antenna.
  - Increase the separation between the equipment and receiver.
  - Connect the equipment into an outlet on a circuit different from that to which the receiver is connected.
  - Consult the dealer or an experienced radio/TV technician for help.

### BATTERY SAFETY INFORMATION

- Non-rechargeable batteries are not to be recharged
- Rechargeable batteries are only to be charged under adult supervision
- Rechargeable batteries are to be removed from the toy before being charged
- Different types of batteries or new and used batteries are not to be mixed
- Batteries are to be inserted with the correct polarity
- Exhausted batteries are to be removed from the toy
- The supply terminals are not to be short-circuited



© 2010 UMI. All rights reserved.  
 ® and TM designate U.S. Trademarks of Uncle Milton Industries, Inc.  
 Product designed, manufactured and assembled in China.  
 © 2010 Lucalifilm Ltd. ® & ® TM where indicated.  
 All rights reserved.